

Type Designation	4920
Designation IEC	LR20
System	Zn-MnO <sub>2</sub> (Alkaline)
Shelf Life (Coding)*	5 years
Nominal Voltage [V]	1.5
Typical Capacity C [mAh]	16500 (discharge with high-resistance)
Permissible Temperature Range	- 10 °C ... 50 °C
Weight, approx. [g]	138
Volume [ccm]	51.3

Dimensions [mm] min: max:

∅	32.3	34.2
A	-	61.5
B	59.5	-
C	18.0	-
E	-	1.0
F	-	9.5
G	1.5	-

### Typical Capacities (at 20°C)

Discharge Type	Load	End Voltage[V]	0.9
4M/15M,8H/D,7D/W	1.5 Ω	Time [h]	14,4
Portable lighting (2)		Capacity [Ah]	10,75
		Energy [Wh]	12,11
Discharge Type	Load	End Voltage[V]	0.9
4M/H,8H/D,7D/W	2.2 Ω	Time [h]	25,2
Portable lighting (1)		Capacity [Ah]	13,21
		Energy [Wh]	15,40
Discharge Type	Load	End Voltage[V]	0.8
1H/D,7D/W	2.2 Ω	Time [h]	28,6
Toy		Capacity [Ah]	14,00
		Energy [Wh]	15,27
Discharge Type	Load	End Voltage[V]	0.9
2H/D,7D/W	600 mA	Time [h]	15,8
Portable stereo		Capacity [Ah]	9,53
		Energy [Wh]	10,56
Discharge Type	Load	End Voltage[V]	0.9
4H/D,7D/W	10 Ω	Time [h]	131,6
Radio		Capacity [Ah]	15,84
		Energy [Wh]	19,27



**No publication or circulation of data to third parties without consent of VARTA Consumer Batteries**

\* In consideration of typical loss of capacity at storage and application.

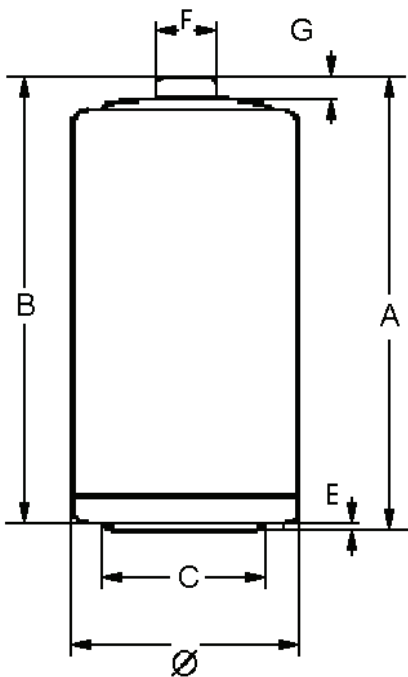

Type Designation	4920
Designation IEC	LR20
System	Zn-MnO <sub>2</sub> (Alkaline)
Shelf Life (Coding)*	5 years
Nominal Voltage [V]	1.5
Typical Capacity C [mAh]	16500 ( discharge with high-resistance)
Permissible Temperature Range	-10 °C ... 50 °C
Weight, approx. [g]	138
Volume [ccm]	51.3
Dimensions [mm]	min:            max:

Ø	32.3	34.2
A	-	61.5
B	59.5	-
C	18.0	-
E	-	1.0
F	-	9.5
G	1.5	-

**Discharge Type:**  
4M/15M, 8 H/D, 7 D/W  
Portable Lighting

**Load: 2,2 Ohm**

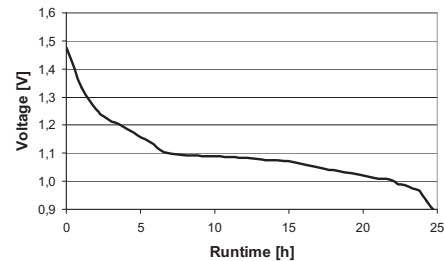

**Discharge Type:**  
4 H/D, 7 D/W  
Transistor Radios

**Load: 10 Ohm**

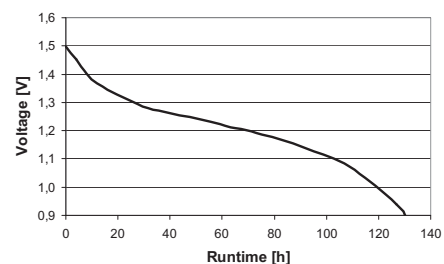

**Discharge Type:**  
2 H/D, 7 D/W  
Portable Stereo

**Load: 600 mA**

