



Sirenas industriales

Electrónicas

140

32 Sonidos



140 150 50
140 160 50



140 950 60

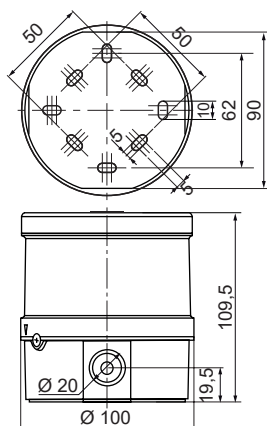

32 Sonidos seleccionables con volumen ajustable
Posibilidad de 2 avisos independientes (versión c.c.)
Aplicación interior/externo IP65

CÓDIGO	TENSIÓN V	CORRIENTE mA	FRECUENCIA Hz
140 150 50	9 - 28 c.c.	< 120	-
140 160 50*	9 - 28 c.c.	< 120	-
140 950 60	110 - 240 c.a.	< 40	50/60

*Normativa EN54-3

Dimensiones: (Altura x Diámetro): 109,5 mm x 100 mm

Construcción: ABS

Terminal: Regleta de conexión máx. 2,5 mm²

Entrada de cable: Prensaestopa M 20 x 1,5 mm (no incluido)

Salida de sonido: Frontal

Accesorios

	Código
Prensaestopa M 20 x 1,5 mm	PSM20N



140 160 50





Señalización ACÚSTICA

Variación teórica de la intensidad sonora respecto a la distancia del emisor (dB)

Es importante recordar que una Señal Acústica reduce en 6 dB su percepción sonora con el doble de la distancia

Ejemplo: 100 dB a 1 metro, significa 94 dB a 2 metros.
94 dB a 2 metros, significa 80 dB a 10 metros.

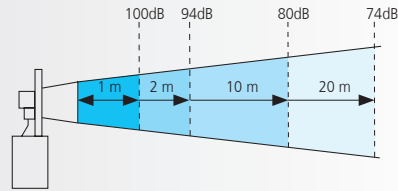

DISTANCIA EN METROS

		1	2	3	5	10	20	30	50	100	200	300	500	1000	2000	3000	5000
8	150	144	140	136	130	124	120	116	110	104	100	96	90	84	80	76	72
	148	142	138	134	128	122	118	114	108	102	98	94	88	82	78	74	70
	146	140	136	132	126	120	116	112	106	100	96	92	86	80	76	72	68
	144	138	134	130	124	118	114	110	104	98	94	90	84	78	74	70	66
	142	136	132	128	122	116	112	108	102	96	92	88	82	76	72	68	64
	140	134	130	126	120	114	110	106	100	94	90	86	80	74	70	66	62
	138	132	128	124	118	112	108	104	98	92	88	84	78	72	68	64	60
	136	130	126	122	116	110	106	102	96	90	86	82	76	70	66	62	58
7	134	128	124	120	114	108	104	100	94	88	84	80	74	68	64	60	56
	132	126	122	118	112	106	102	98	92	86	82	78	72	66	62	58	54
	130	124	120	116	110	104	100	96	90	84	80	76	70	64	60	56	52
	128	122	118	114	108	102	98	94	88	82	78	74	68	62	58	54	50
	126	120	116	112	106	100	96	92	86	80	76	72	66	60	56	52	48
	124	118	114	110	104	98	94	90	84	78	74	70	64	58	54	50	46
	122	116	112	108	102	96	92	88	82	76	72	68	62	56	52	48	44
	120	114	110	106	100	94	90	86	80	74	70	66	60	54	50	46	42
6	118	112	108	104	98	92	88	84	78	72	68	64	58	52	48	44	40
	116	110	106	102	96	90	86	82	76	70	66	62	56	50	46	42	38
	114	108	104	100	94	88	84	80	74	68	64	60	54	48	44	40	36
	112	106	102	98	92	86	82	78	72	66	62	58	52	46	42	38	34
	110	104	100	96	90	84	80	76	70	64	60	56	50	44	40	36	32
	108	102	98	94	88	82	78	74	68	62	58	54	48	42	38	34	30
	106	100	96	92	86	80	76	72	66	60	56	52	46	40	36	32	28
	104	98	94	90	84	78	74	70	64	58	54	50	44	38	34	30	26
5	102	96	92	88	82	76	72	68	62	56	52	48	42	38	34	30	26
	100	94	90	86	80	74	70	66	60	54	50	46	40	36	32	28	24
	98	92	88	84	78	72	68	64	58	52	48	44	38	34	30	26	22
	96	90	86	82	76	70	66	62	56	50	46	42	36	32	28	24	20
	94	88	84	80	74	68	64	60	54	48	44	40	34	30	26	22	18
	92	86	82	78	72	66	62	58	52	46	42	38	32	28	24	20	16
	90	84	80	76	70	64	60	56	50	44	40	36	30	26	22	18	14
	88	82	78	74	68	62	58	54	48	42	38	32	28	24	20	16	12
4	86	80	76	72	66	60	56	52	46	40	36	30	26	22	18	14	10
	84	78	74	70	64	58	54	50	44	38	32	28	24	20	16	12	8
	82	76	72	68	62	56	52	48	42	36	30	26	22	18	14	10	6
	80	74	70	66	60	54	50	46	40	34	28	24	20	16	12	8	4
	75	69	65	61	55	49	45	41	35	29	23	18	14	10	6	2	0
	70	64	60	56	50	44	40	36	30	24	18	12	8	4	0	0	0
	65	59	55	51	45	39	35	31	25	19	13	8	4	0	0	0	0
	60	54	50	46	40	34	28	24	18	12	6	0	0	0	0	0	0
3	55	49	45	41	35	29	23	18	12	6	0	0	0	0	0	0	0
	50	44	40	36	30	24	18	12	6	0	0	0	0	0	0	0	0
	45	39	35	31	25	19	13	8	4	0	0	0	0	0	0	0	0
	40	34	30	26	20	14	8	4	0	0	0	0	0	0	0	0	0
	35	29	25	21	15	9	5	1	0	0	0	0	0	0	0	0	0
	30	24	20	16	10	6	2	0	0	0	0	0	0	0	0	0	0
	25	19	15	11	7	3	0	0	0	0	0	0	0	0	0	0	0
	20	14	10	6	3	0	0	0	0	0	0	0	0	0	0	0	0
2	15	9	6	3	0	0	0	0	0	0	0	0	0	0	0	0	0
	10	4	1	0	0	0	0	0	0	0	0	0	0	0	0	0	0
	5	0	0	0	0	0	0	0	0	0	0	0	0	0	0	0	0
	0	0	0	0	0	0	0	0	0	0	0	0	0	0	0	0	0
	0	0	0	0	0	0	0	0	0	0	0	0	0	0	0	0	0
	0	0	0	0	0	0	0	0	0	0	0	0	0	0	0	0	0
	0	0	0	0	0	0	0	0	0	0	0	0	0	0	0	0	0
	0	0	0	0	0	0	0	0	0	0	0	0	0	0	0	0	0
1	0	0	0	0	0	0	0	0	0	0	0	0	0	0	0	0	0
	0	0	0	0	0	0	0	0	0	0	0	0	0	0	0	0	0
	0	0	0	0	0	0	0	0	0	0	0	0	0	0	0	0	0
	0	0	0	0	0	0	0	0	0	0	0	0	0	0	0	0	0
	0	0	0	0	0	0	0	0	0	0	0	0	0	0	0	0	0
	0	0	0	0	0	0	0	0	0	0	0	0	0	0	0	0	0
	0	0	0	0	0	0	0	0	0	0	0	0	0	0	0	0	0
	0	0	0	0	0	0	0	0	0	0	0	0	0	0	0	0	0



dB [A] 0 10 20 30 40 50 60 70 80 90 100 110 120 130 140 150

NIVEL DE SONIDO: 1 2 3 4 5 6 7 8

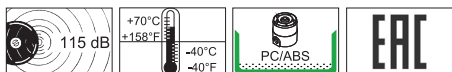

140 x60 50 140 x50 50 140 x50 60



VdS	140 160 50	G214111
	140 960 50	G214111

DIN-EN 54-3

Typ B für Außenanwendung.

Erfüllt alle Anforderungen als Typ A für Innenanwendung.

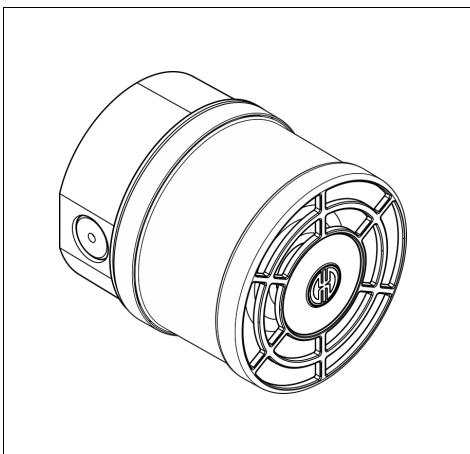

310.140.002.0115

© D

WERMA Signaltechnik GmbH + Co. KG
 D-78604 Rietheim-Weilheim
 Telefon +49 (0)7424 / 9557-0
 Telefax +49 (0)7424 / 9557-44
 info@werma.com
 www.werma.com



- Ⓓ Anschluss **ausschließlich** durch ausgebildete Elektro-Fachkräfte.
- Ⓔ Electrical connection is to be made by trained electrical specialists **only**.
- Ⓕ Le branchement doit **uniquement** être effectué par des professionnels.
- Ⓖ Il collegamento deve essere eseguito **solo** da elettricisti specializzati.
- Ⓔ La conexión **sólo** debe ser realizada por electricistas debidamente formados.
- Ⓕ A ligação deve ser feita **exclusivamente** por profissional elétrico especializado.
- Ⓖ De aansluiting mag **enkel** gebeuren door erkende vakmensen.
- Ⓕ Připojení smí **provádět** pouze kvalifikovaný personál.
- Ⓖ Podłączenie **wyłącznie** przez specjalistów-elektryków.
- Ⓕ Liittäminen kuuluu **ainoastaan** koulutettujen sähköalan ammattilaisten tehtäviin.
- Ⓖ Подключение проводится только специалистом-электриком.
- Ⓕ Bağlantı **sadece** eğitimli elektrik teknisyenleri tarafından yapılmalıdır.
- Ⓖ 布线需由专业电工执行

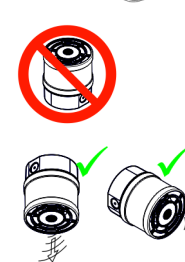
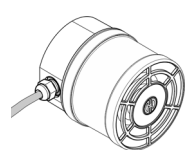
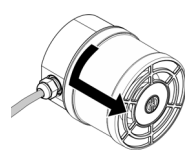

140 x50 50	9 ... 28 VDC, max. 120 mA
140 x60 50	9 ... 13,5/13,5 ... 28 VDC
	10-120 mA
	Tone 3 12 V, 22 mA
	Tone 8 12 V, 21 mA
140 x50 60	110 ... 240 V AC, max. 40 mA



○ = VdS geprüfte Töne / VdS tested Tone /
 Ton éprouvé (VdS)

(vgl. Abb. 6,7 see Fig. 6,7 Ref. III 6,7)

Code	Ton Tone Ton A	Tonart Tone type Tonalité	Beschreibung Description Description	Lautstärke Volume Intensité (dBA)±2dB	Ton Tone Ton B
12345				12 V 24V	
00000	1	alternierend/alternating/alternant 800/970Hz im 2Hz-Takt/2Hz stroke/cycle	BS5839-1:2002	101	105 14
00001	2	ansteigend/rising/mon- tant 800/970Hz im 7Hz-Takt/7Hz stroke/ cycle		103	107 14
00010	③	ansteigend/rising/mon- tant 800/970Hz im 1Hz-Takt/1Hz stroke/ cycle	BS5839-1:2002 VDS EN54-3	104	108 14
00011	4	Dauerton/continuous tone/continu 2850Hz		110	115 14
00100	5	ansteigend/rising/mon- tant 2400-2850Hz im 7Hz-Takt/7Hz stroke/ cycle		108	114 4
00101	6	ansteigend/rising/mon- tant 2400-2850Hz im 1Hz-Takt/1Hz stroke/ cycle		109	115 4
00110	7	ansteigend/rising/mon- tant 500-1200Hz:3s/ AUS/OFF/ARRÊT:0.5s		100	104 14
00111	⑧	abfallend/falling/incline 1200-500Hz im 1Hz-Takt/1Hz stroke/cycle	VDS EN54-3	99	104 14
01000	9	alternierend/alternating/alternant 2400/2850Hz im 2Hz-Takt/2Hz stroke/cycle		108	115 4
01001	10	pulsierend/pulse/pul- sant 970Hz im 0,5Hz-Takt/0,5Hz stroke/ cycle		98	105 14
01010	11	alternierend/alternating/alternant 800/970 Hz im 1Hz Takt/1Hz stroke/cycle		100	105 14
01011	12	pulsierend/pulse/pul- sant 2850Hz im 0,5Hz-Takt/0,5Hz stroke/ cycle		107	114 4
01100	13	970Hz getaktet/cyclical/en cadence: 1/4s AN/ON/MARCHE, 1s AUS/OFF/ARRÊT		96	105 14
01101	14	Dauerton/continuous tone/continu 970Hz	BS5839-1:2002	101	105 15
01110	15	554Hz für/for/pour 100 ms und/and/et 440Hz für/for/pour 400 ms	Französisches Brandmelde- signal/Système d'alert français	97	102 14

01111	16	pulsierend/pulse/pul- sant 660Hz 150ms AN/ON/MARCHE 150ms AUS/OFF/ ARRÊT		97	101 17
10000	17	pulsierend/pulse/pul- sant 660Hz für/for/ pour 1.8s AN/ON/ MARCHE, 1.8s AUS/ OFF/ARRÊT		97	103 16
10001	18	pulsierend/pulse/pul- sant 660Hz für/for/ pour 6.5 s AN/ON/ MARCHE, 13s AUS/ OFF/ARRÊT		99	103 14
10010	19	Dauerton/continuous tone/continu 660Hz		99	103 21
10011	20	alternierend/alternating/alternant 554/440 Hz im/in 0,5Hz-Takt/ 0,5Hz stroke/cycle		99	103 21
10100	21	pulsierend/pulse/pul- sant 660Hz im 1Hz-Takt/1Hz stroke/cycle		98	104 19
10101	22	pulsierend/pulse/pul- sant 2850Hz 150ms AN/ON/MARCHE, 100ms AUS/OFF/ ARRÊT		109	115 14
10110	23	ansteigend/rising/mon- tant 800/970Hz im 50Hz-Takt/50Hz stroke/cycle		101	106 14
10111	24	ansteigend/rising/mon- tant 2400-2850Hz im 50Hz-Takt/50Hz stroke/cycle		106	112 4
11000	25	pulsierend/pulse/pul- sant 970Hz 1.5s AN/ON/MAR- CHE, 0.5s AUS/OFF/ ARRÊT	ISO 8201 Niedrige Frequenz/low fre- quency/fréquence basse	101	105 26
11001	26	pulsierend/pulse/pul- sant 2850Hz 0.5s AN/ON/MARCHE, 0.5 s. AUS/OFF/ARRÊT	ISO 8201 Hohe Frequenz/high fre- quency/fréquence haute	109	115 25
11010	27	alternierend/alternating/alternant 970/800 Hz 1.5s AN/ON/MAR- CHE, 0.5s AUS/OFF/ ARRÊT		96	105 17
11011	28	alternierend/alternating/alternant 800/970 Hz im 2Hz-Takt/2Hz stroke/cycle	BS 5839-1:2002	99	105 10
11100	29	alternierend/alternating/alternant 988/645 Hz im 2Hz-Takt/2Hz stroke/cycle		99	104 988 Hz ¹⁾
11101	30	alternierend/alternating/alternant 510/610 Hz im 2Hz-Takt/2Hz stroke/cycle		97	102 510 Hz ¹⁾
11110	31	abfallend/falling/incline 1200-300Hz im 1Hz-Takt/1Hz stroke/cycle		99	104 13
11111	32	alternierend/alternating/alternant 510/610 Hz im 1Hz-Takt/1Hz stroke/cycle		97	102 510 Hz ¹⁾

1) Dauerton/continuous tone/tone continu

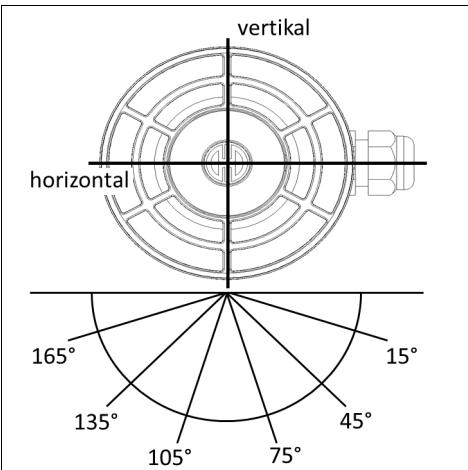

	[dB] in 1 m	Ton 3			Ton 8		
		9 V	13,5 V	28 V	9 V	13,5 V	28 V
horizontal	15°	80	85	89	80	85	89
	45°	86	91	95	87	91	96
	75°	89	95	99	88	94	98
	105°	89	95	100	89	94	99
	135°	86	92	96	87	92	96
vertikal	15°	80	85	87	80	84	89
	45°	86	91	95	86	92	97
	75°	89	95	100	89	94	98
	105°	89	95	100	89	94	99
	135°	87	91	95	87	92	96
165°	79	84	88	79	85	89	

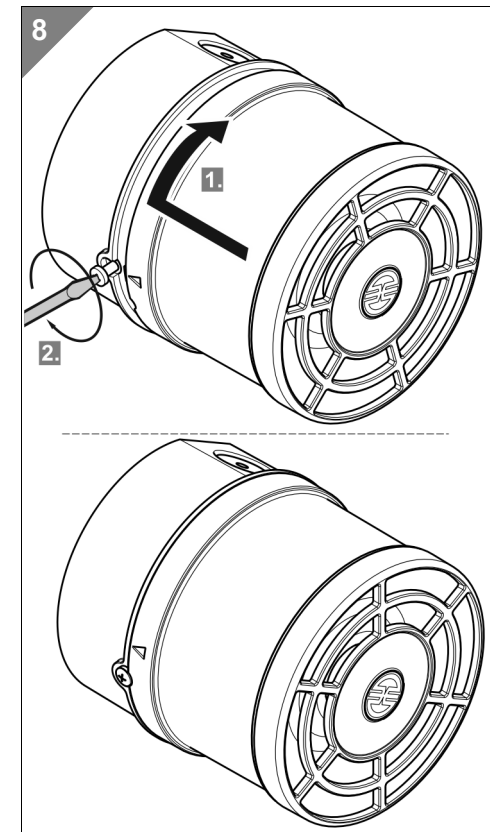
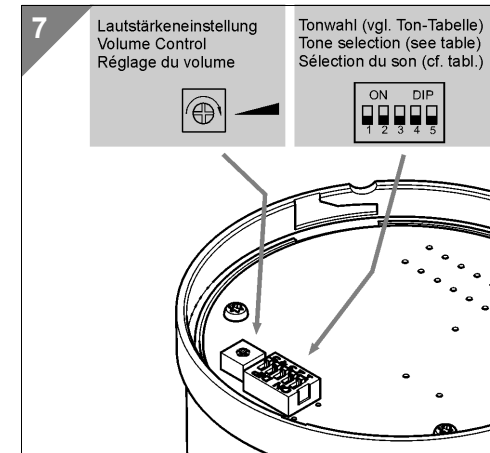
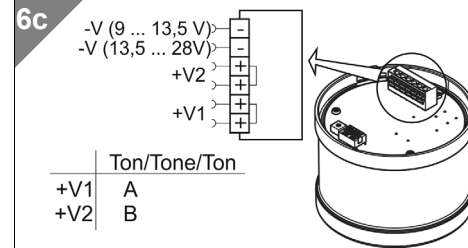
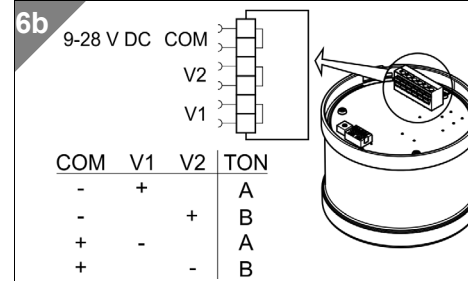
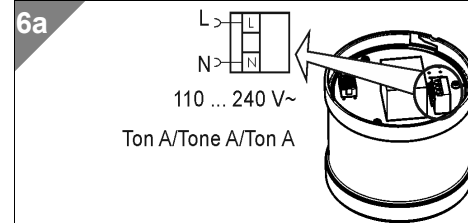
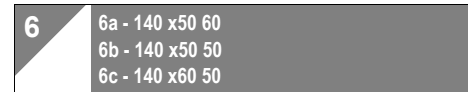
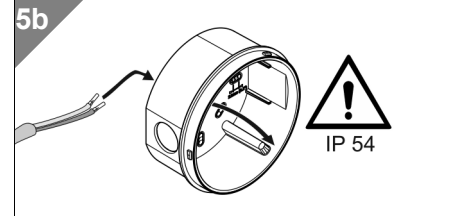
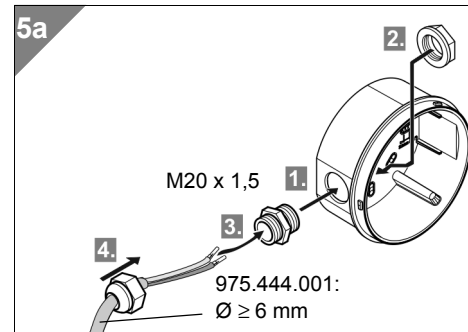
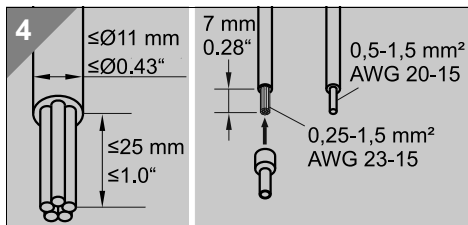
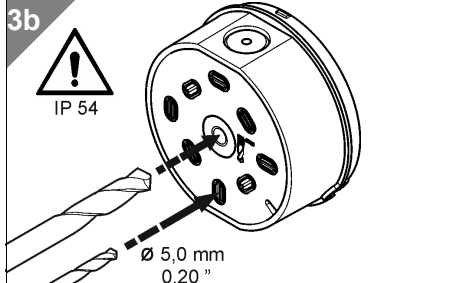
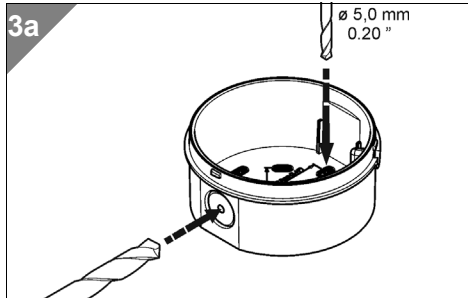
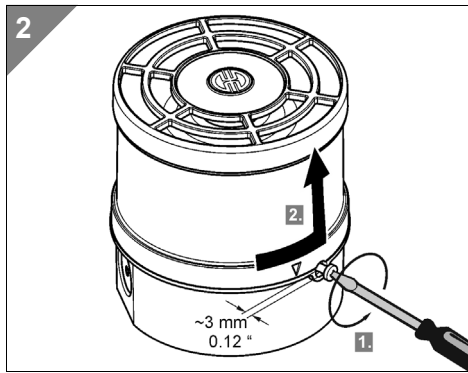
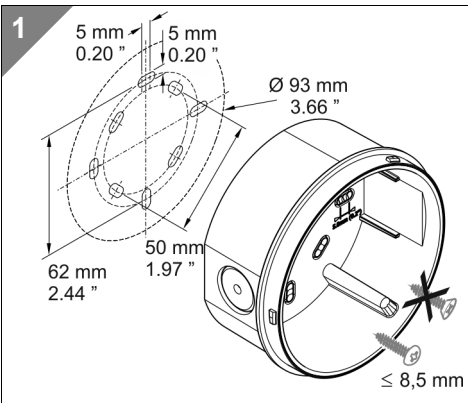
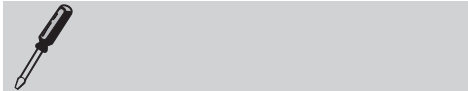

310.140.002.0115

© D

WERMA
SIGNALTECHNIK