

ø 4 mm CONNECTORS
Male and female plugs

CONNECTEURS ø 4 mm
Fiches mâles et femelles

ø 4 mm STECKVERBINDER
Stecker und Kupplungen



Male plug - Screwable insulator - Solder connection
Fiche mâle - Isolant vissable - Raccord soudure
ø 4 mm Stecker - Schraubisolator - Lötanschluss

Type 1

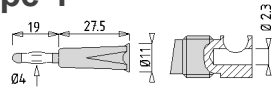

Male plug - Screwable insulator - M.3 screw connection
Fiche mâle - Isolant vissable - Raccord vis M.3
ø 4 mm Stecker - Schraubisolator - M.3 Schraubanschluß

Type 2

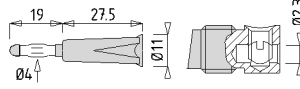

Type 3 Hex. plug - M.3 thread connection
Fiche panneau - Raccord filetage M.3
Plattenstecker - M.3 Gewindeanschluss

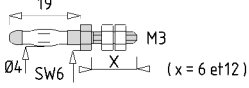

Type 4 Hex. plug - M.3 Thread + 2 nuts
Fiche panneau - Filetage M.3 + 2 écrous
Plattenstecker - M.3 Gewindeanschluss mit 2 Muttern

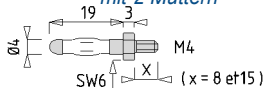

Type 5 Hex. plug - M.4 thread connection
Fiche panneau - Raccord filetage M.4
Plattenstecker - M.4 Gewindeanschluss

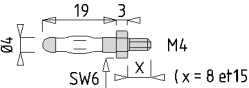

Type 6 Standard male plug - Quick connection
Fiche mâle simple - Raccord rapide
Standardstecker - Druckanschluss

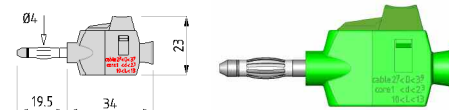

Stackable and ordinary ø 4 safety plugs
See page 45 P/N 1061 - 1063 - 1065 - 1066 - 1067 and 1068

Fiches de sécurité, simples et à reprise arrière ø 4
Voir page 45 Réf. 1061 - 1063 - 1065 - 1066 - 1067 et 1068

Einfache und stapelbare ø 4 Sicherheitsstecker
Siehe Seite 45 Bestell-Nr 1061 - 1063 - 1065 1066 - 1067 und 1068

Male plug, assembly without tool
M3 screw connection (Au/Ni possible)
Fiche mâle encliquetable sans outil
raccord vis M3 (Au/Ni possible)
Stecker, montierbar ohne Werkzeug
M3 Schraubanschluss (Gold auf Anfrage)



Type 7

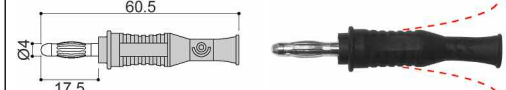

Rear output male plug - M.3 screw connection
Fiche mâle + reprise arrière - Raccord vis M.3
Stecker - stapelbar - M.3 Schraubanschluss

Type 8

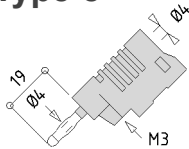

Ditto type 8 + lateral outputs (1 ø 4 - 2 ø 2)
Idem type 8 + reprises latérales (1 ø 4 - 2 ø 2)
Wie Typ 8 + seitlich stapelbar (1 ø 4 - 2 ø 2)

Type 9

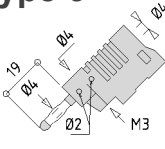

Rear output male plug - Quick connection
Fiche mâle + reprise arrière - Raccord rapide
Stecker - stapelbar - Druckanschluss

Type 10

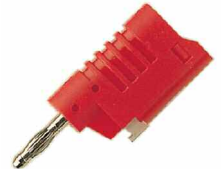
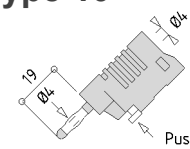

Ditto type 10 + lateral outputs (1 ø 4 - 2 ø 2)
Idem type 10 + reprises latérales (1 ø 4 - 2 ø 2)
Wie Typ 10 + seitlich stapelbar (1 ø 4 - 2 ø 2)

Type 11

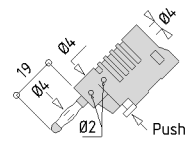

Female plug - Screwable insulator - Solder connection
Fiche femelle - Isolant vissable - Raccord soudure
Kupplung - Schraubisolator - Lötanschluss

Type 12

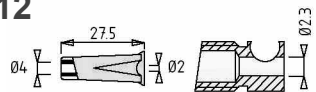

Female plug - Screwable insulator - M.3 screw connection
Fiche femelle - Isolant vissable - Raccord vis M.3
Kupplung - Schraubisolator - M.3 Schraubanschluss

Type 13

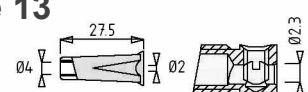

PARTIAL PROTECTION ø 4 MALE PLUGS
FICHES MÂLES ø 4, PROTECTION PARTIELLE
STECKER ø 4, TEILWEISER SCHUTZ

Rear output ø 4 male plug - Connection : screw
Retractable shield sleeve
Fiche mâle ø 4 mm reprise arrière - Raccord : vis -
Fourreau protecteur rétractable
ø 4 Stecker stapelbar - Schraubanschluss-retraktierbares Schutzrohr

Type 14

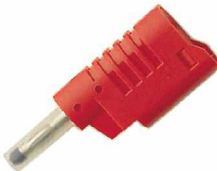
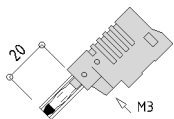

Rear output ø 4 male plug - Quick connection
Retractable shield sleeve
Fiche mâle ø 4 mm reprise arrière - Raccord rapide
- Fourreau protecteur rétractable
ø 4 Stecker stapelbar - Druckanschluss-retraktierbares Schutzrohr

Type 15

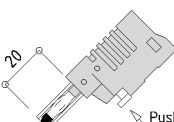

Type	Reference Référence Bestell-Nr	Maximum current I admissible Bemessungsstrom	Voltage Tension Bemessungs-spannung	Pack	Colours - Couleurs - Farben					
					R	N	Bl	V	J	Bc
1	1010 - C - # 1010 - I - #	36 A	< 33 V AC < 70 V DC Required limit by IEC 61010-1/61010-031 Limite exigée par CEI 61010-1/61010-031 Grenzwert erfordert von IEC 61010-1/61010-031	100	•	•	•	•	•	•
2	1060 - C - # 1060 - I - #			100	•	•	•	•	•	•
3	1050 - 6 1050 - 12			100						
4	1052 - 6 1052 - 12			100						
5	1054 - 8 1054 - 15	100								
6	1064-PRO-#	20 A		50	•	•	•	•	•	•
7	1069-PRO-#	20 A		10	•	•	•	•	•	•
8	1080 - #			50	•	•	•	•	•	•
9	1084 - #			10	•	•	•	•	•	•
10	1087 - #	36 A		10	•	•	•	•	•	•
11	1090 - #			10	•	•	•	•	•	•
12	3010 - C - # 3010 - I - #			100	•	•	•	•	•	•
13	3030 - C - # 3030 - I - #			100	•	•	•	•	•	•
14	1086 - #			100	•	•	•	•	•	•
15	1089 - #	10		•	•	•	•	•	•	
					2	0	6	5	4	9