

# Speakon® Series



FC Cable Connectors



Chassis Connectors



SPX Cable Connectors



STX Cable Connectors



STX Chassis Connectors

		FC Cable Connectors	Chassis Connectors	SPX Cable Connectors	STX Cable Connectors	STX Chassis Connectors
<b>Electrical</b>						
<b>Number of contacts</b>		2, 4, 8	2, 4, 8	4	4, 8	4, 8
<b>Rated current per contact</b>	30 A	●	●	-	-	-
	40 A	-	-	●	●	●
<b>Isolated Voltage</b>	250 V ac	●	●	●	●	●
<b>Termination</b>	PCB	-	●	-	-	●
	FASTON® - Solder	-	●	-	-	●
	Screw Terminals	●	●	●	-	-
	Solder Terminals	-	-	-	●	●
<b>Mounting</b>	Thru holes	-	●	-	-	●
	Self tapping screw holes (A screw)	-	●	-	-	●
	Metal M3 thread	-	●	-	-	-
<b>Shell</b>		Plastic	Plastic	Plastic	Metall	Metall





Reinforced locking area



Nickel housing



3/16" flat tabs



Vertical PCB mount



## s p e a k O N Chassis Connector



NL2MP



NL4MD-H-1



NL4MD-H-3



NL4MPR



NL8MPR

- Standard version up to 30 A rms, ultra high current version up to 50 A audio current
- Glass reinforced materials
- Precise keyway for secure mating
- Accurate twist lock latching system
- Metal front plate (8-pole) or metal insert in locking area (2 & 4-pole)
- Various mounting and wiring possibilities
- "Air tight design", optimized for speaker applications
- D or G panel cutouts to be easily mounted on audio industry standard panels
- 4 pole branded with unique hologram

### NL4MD-V

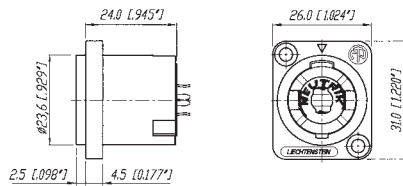

### NL4MD-H

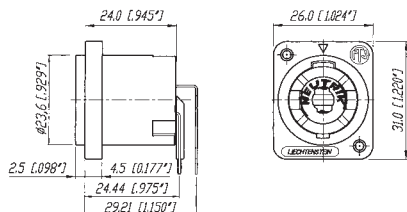

### NL4MP

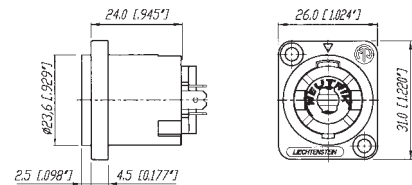

### NL4MPR

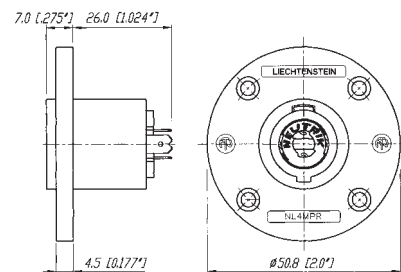

### NL8MPR

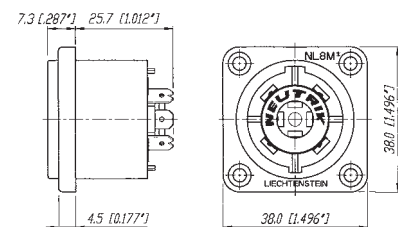

---

**Product**

Title	NL8MPR
-------	--------

---

Connection Type	speakON
-----------------	---------

---

Gender	male
--------	------

---

**Electrical**

Contact resistance	$\leq 3 \text{ m}\Omega$ (inner) (after lifetime)
--------------------	---

---

Dielectric strength	4 kVdc (peak)
---------------------	---------------

---

Insulation resistance	$> 1 \text{ G}\Omega$ (after dampheat)
-----------------------	--

---

Rated current per contact	30 A rms continuous
---------------------------	---------------------

---

Rated current per contact	40 A audiosignal, duty cycle 50 %
---------------------------	-----------------------------------

---

Rated voltage	250 V (Insulation)
---------------	--------------------

---

Attention	speakON is NOT to be used as an AC mains or power supply connector!
-----------	---

---

**Mechanical**

Lifetime	$> 5000$ mating cycles
----------	------------------------

---

Locking device	Quick Lock
----------------	------------

---

Chassis shape	square G-size flange
---------------	----------------------

---

Layout	four thru holes
--------	-----------------

---

**Material**

Contact plating	4 $\mu\text{m}$ Ag
-----------------	--------------------

---

Contacts	Bronze (CuSn6)
----------	----------------

---

Shell	Polyamide (PA 6 30 % GR) Ni
-------	-----------------------------

---

**Environmental**